

Preserve Outdoor Collaboration / PSV1

Single Unit Product Specifications

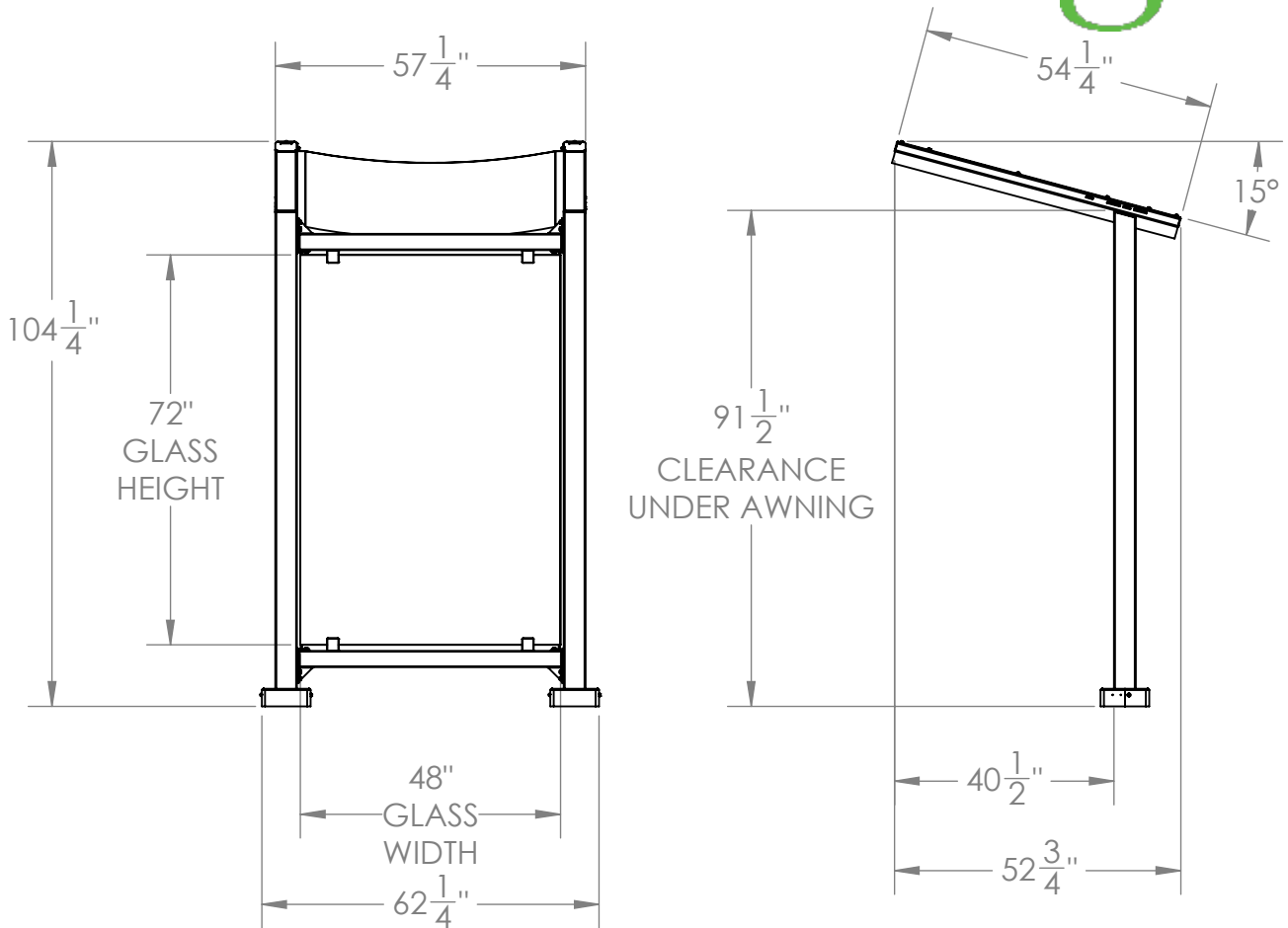

Materials:

- Structural steel frame with architectural grade powder coating.
- Safety glass formed with two tempered glass panels with EVA interlayer.
- Composite decking lumber, comprised of 90% recycled material.
- Sunbrella water repellant UV-rated awning.

Features:

- Available in three standard layouts - Single, Double, and Canopy options. (Single shown)
- Awnings and extension arms optional.
- Optional Surfaces: 6'H x 4'W Collaboration Glassboard and/or 6'H x 4'W Slat Wall.
- Three architectural powder coat colors: Black, Classic Grey, Anodized Silver.
 - Colors adhere with Bureau of Land Management's environmental color requirements.
- Seven standard outdoor awning color options available.
- Three standard Slat Wall colors: Walnut, Teak, Stone.
- Professional Engineering (PE) stamp approval for various US states - contact your Ghent representative for location specific stamp approval.
- Warranty: 10 Year Structural, 2 Year Finish.

Notes:

- Site review needed prior to installation.

Preserve Outdoor Collaboration / PSV2

Product Specifications

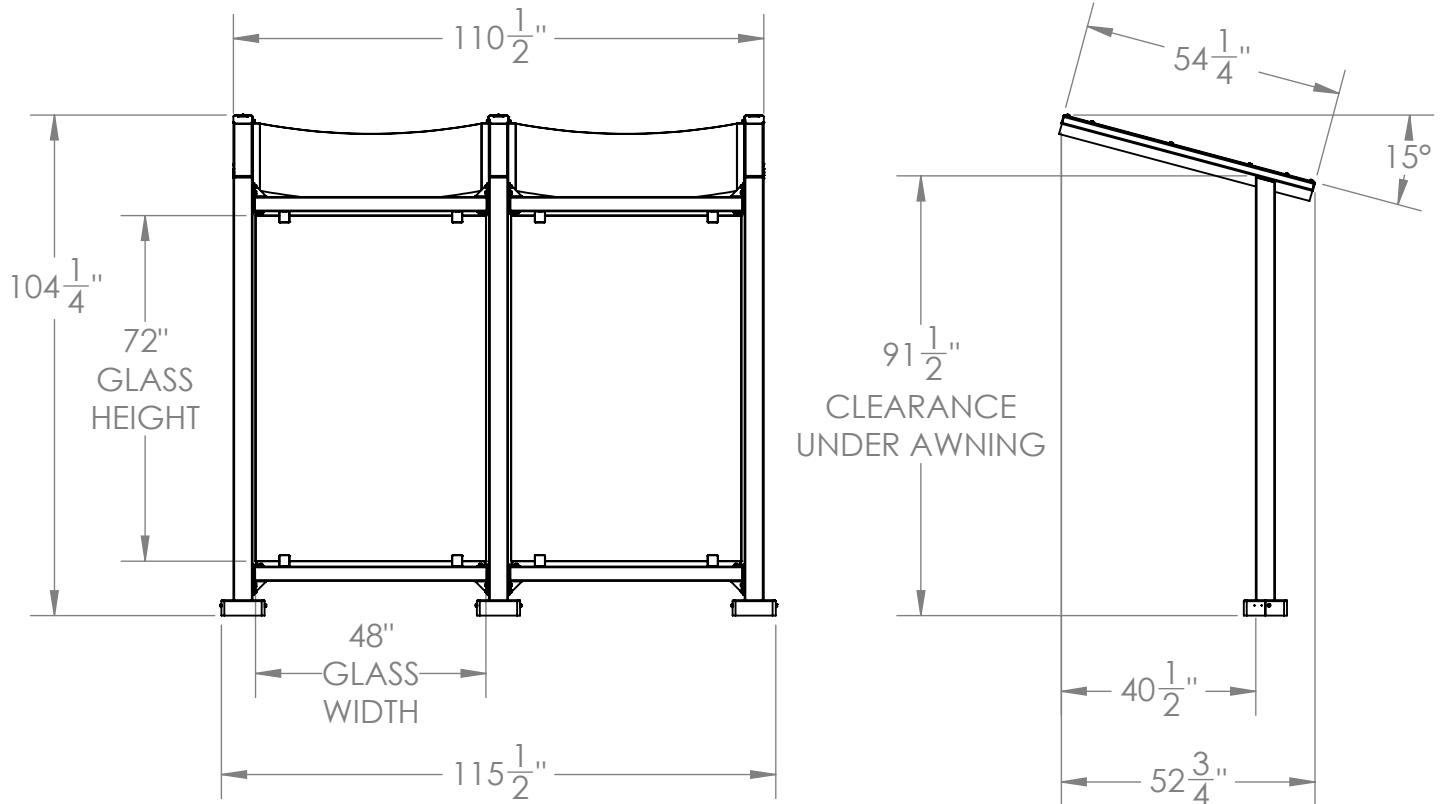

Materials:

- Structural steel frame with architectural grade powder coating.
- Safety glass formed with two tempered glass panels with EVA interlayer.
- Composite decking lumber, comprised of 90% recycled material.
- Sunbrella water repellant UV-rated awning.

Features:

- Available in three standard layouts - Single, Double, and Canopy options. (Double shown)
- Awnings and extension arms optional.
- Optional Surfaces: 6'H x 4'W Collaboration Glassboard and/or 6'H x 4'W Slat Wall.
- Three architectural powder coat colors: Black, Classic Grey, Anodized Silver.
 - Colors adhere with Bureau of Land Management's environmental color requirements.
- Seven standard outdoor awning color options available.
- Three standard Slat Wall colors: Walnut, Teak, Stone.
- Professional Engineering (PE) stamp approval for various US states - contact your Ghent representative for location specific stamp approval.
- Warranty: 10 Year Structure, 2 Year Finish.

Notes:

- Site review needed prior to installation.

Preserve Outdoor Collaboration / PSV3

Product Specifications

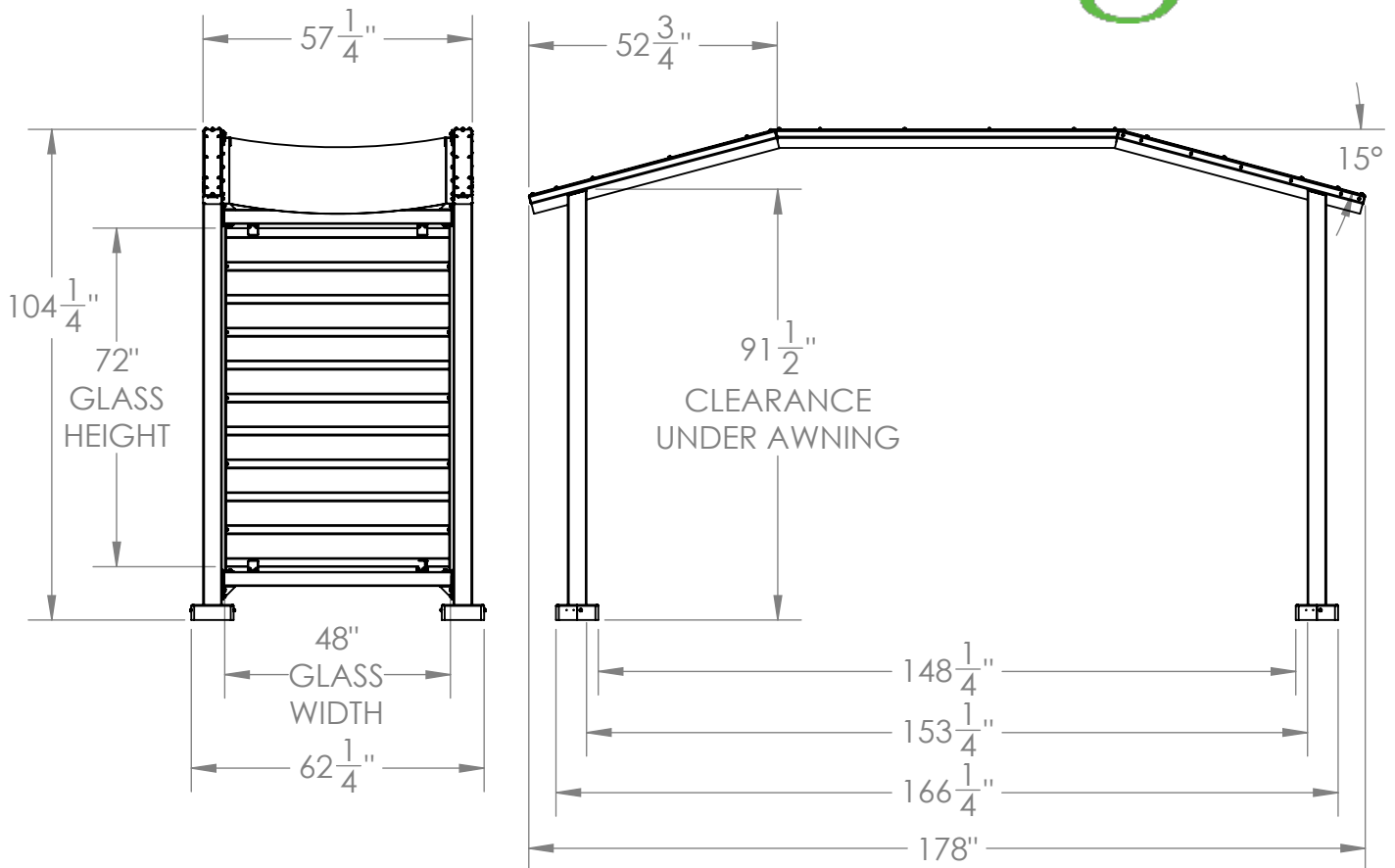

Materials:

- Structural steel frame with architectural grade powder coating.
- Safety glass formed with two tempered glass panels with EVA interlayer.
- Composite decking lumber, comprised of 90% recycled material.
- Sunbrella water repellant UV-rated awning.

Features:

- Available in three standard layouts - Single, Double, and Canopy options. (Canopy shown)
- Awnings and extension arms optional.
- Optional Surfaces: 6'H x 4'W Collaboration Glassboard and/or 6'H x 4'W Slat Wall.
- Three architectural powder coat colors: Black, Classic Grey, Anodized Silver.
 - Colors adhere with Bureau of Land Management's environmental color requirements.
- Seven standard outdoor awning color options available.
- Three standard Slat Wall colors: Walnut, Teak, Stone.
- Professional Engineering (PE) stamp approval for various US states - contact your Ghent representative for location specific stamp approval.
- Warranty: 10 Year Structural, 2 Year Finish.

Notes:

- Site review needed prior to installation.